

Table Of Contents

Introduction

Pg.1

Hollow Metal Doors

Injected Polyurethane Core Doors

Pg.2

Honey Comb Paper Core Doors

Pg.3

Fire rated doors

Pg.4

Lead Lined Doors (radiation shield)

Pg.5

Seamless / Security Doors

Pg.6

Double Egress Metal Doors and Frames

Pg.7

Radiation Shielding Hellow Metal Door and Frame Assemblies

Pg.8

Nomenclature for Standard Doors Designs

Pg.9

Louver Options

Pg.10

Hollow Metal Doors Frames

Frame Type

Pg.12-11

Standard Frame Features

Pg.13

Door Frame Profiles

Pg.14

UL Certification

Pg.15-16

List of high profile projects

Pg.17

BUILDING A FRAMEWORK FOR SUCCESS

Saudi Anfal Hollow Metal Door Division was Founded in 2006 by Saudi Anfal for Automatic Doors and System to fill a void in the hollow metal industry. At that time , there were few custom manufacturers who could make special doors and Frames on a very short lead time .

More than 10 years later , we have built our reputation as the service company that manufactures hollow metal doors and frames. Our expanded manufacturing facility is equipped with the most modern and advanced machinery available. With Knowledgeable and experienced personnel continually striving for innovation and advancement , we are paving the way for the future of the hollow metal door industry.

Saudi Anfal Hollow Metal Doors is proud to be manufacturer of custom hollow metal doors and frames on some of the most prestigious building projects in the Kingdom of Saudi Arabia and GCC . Our on-time delivery supports the growing demand for fast track construction ; Saudi Anfal is staffed to meet our scheduled commitments.

Our quality assurance meets or exceeds that required by SDI 100 , ANSI 8250. Our fire rated products are tested and listed in strict compliance with provisions of NFPA 80 , NFPA 252 , UL 10B & UL 10C

MANUFACTURING PHOTOS



INDUSTRY AFFILIATIONS





ADVANTAGE

1. High thermal Insulation
2. Light Weight

STANDARD FEATURES

1. 44 mm standard door thickness
2. Galvanized Iron G40, G60 & G90
3. Interlocking mechanical seams full height of door
4. injected polyurethane core density 35-45 kg/m³
5. 1.5mm G.I. hardware internal reinforcements
6. 4.5mm hinge reinforcement
7. heavyduty galvanized flush top cap
8. heavy duty galvanized inverted bottom cap

MATERIAL OPTIONS

1. 1.2mm or 1.5 mm door skin
2. Rust inhibitive epoxy primer coat
ANSI SDI 250, 10 or powder coated as per
required RAL color.



HONEY COMB CORE DOORS

ADVANTAGE

Good sound insulation
Light weight

STANDARD FEATURES

1. 44 mm standard door thickness
2. Galvanized Iron G40, G60 & G90
3. Interlocking mechanical seam full height of door
4. Honey comb paper core
5. 1.5mm G.I. hardware internal reinforcements
6. 5mm hinge reinforcements
7. heavy duty galvanized flush top cap
8. heavy duty galvanized inverted bottom cap

MATERIAL OPTIONS

1. 1.2mm or 1.5mm door skin
2. Rust inhibitive epoxy primer coat
ANSI SDI 250, 10 or powder coated as per required RAL color.



MINERAL ROCKWOOL CORE DOOR

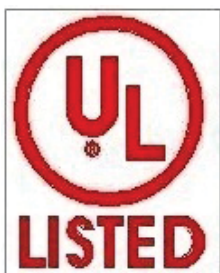
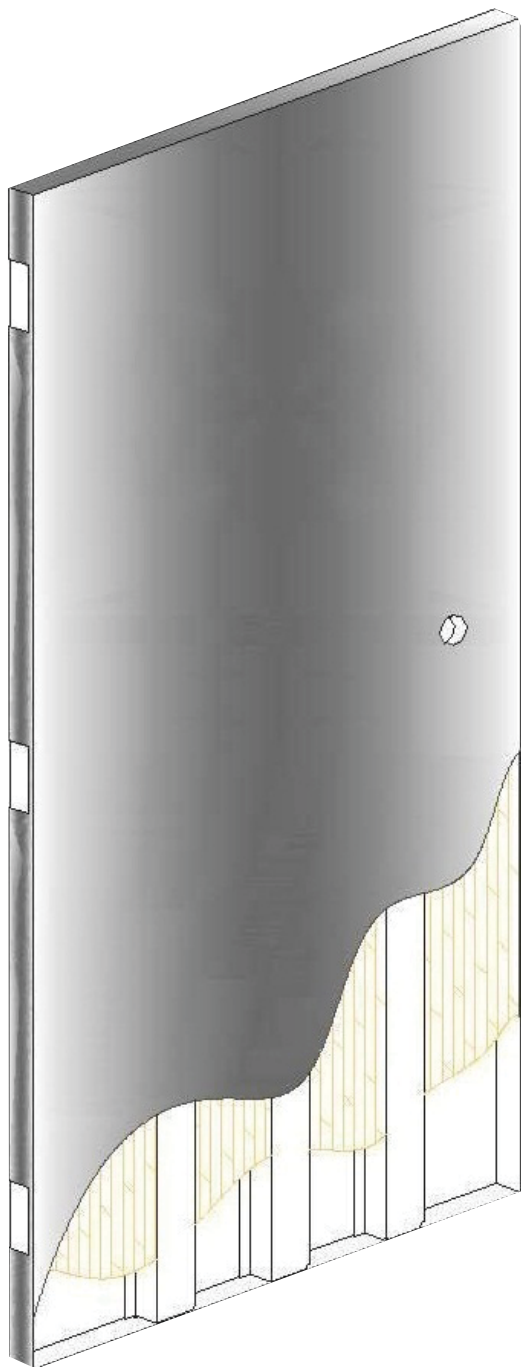

ADVANTAGE

1. Fire Rated
2. Heavy duty door
3. excellent sound absorbance

STANDARD FEATURES

1. 44 mm standard door thickness
2. Galvanized Iron G40, G60 & G90
3. Interlocking mechanical seams full height of door
4. mineral Rockwool insulation density - 100 kg/m³
5. 1.5 mm G.I. hardware internal reinforcements
6. 6mm hinge reinforcements
7. heavy duty galvanized flush top cap
8. heavy duty galvanized inverted bottom cap
9. Hat channel stiffener - 1.5mm G.I for fire rated Doors

MATERIAL OPTIONS

1. 1.2 mm or 1.5mm door skin
2. Rust inhibitive epoxy primer coat
ANSI SDI 250, 10 or powder coated as per required RAL color.

FIRE RATING OPTIONS

1. ANSI/UL 10B, "fire test of door Assemblies," maximum 3 hours fire rated.
2. ANSI/UL 10C, "fire test of door Assemblies," maximum 1-1/2 hours fire rated.

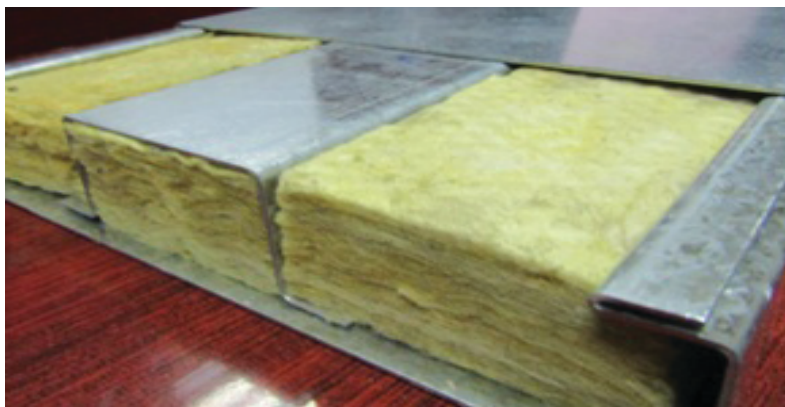

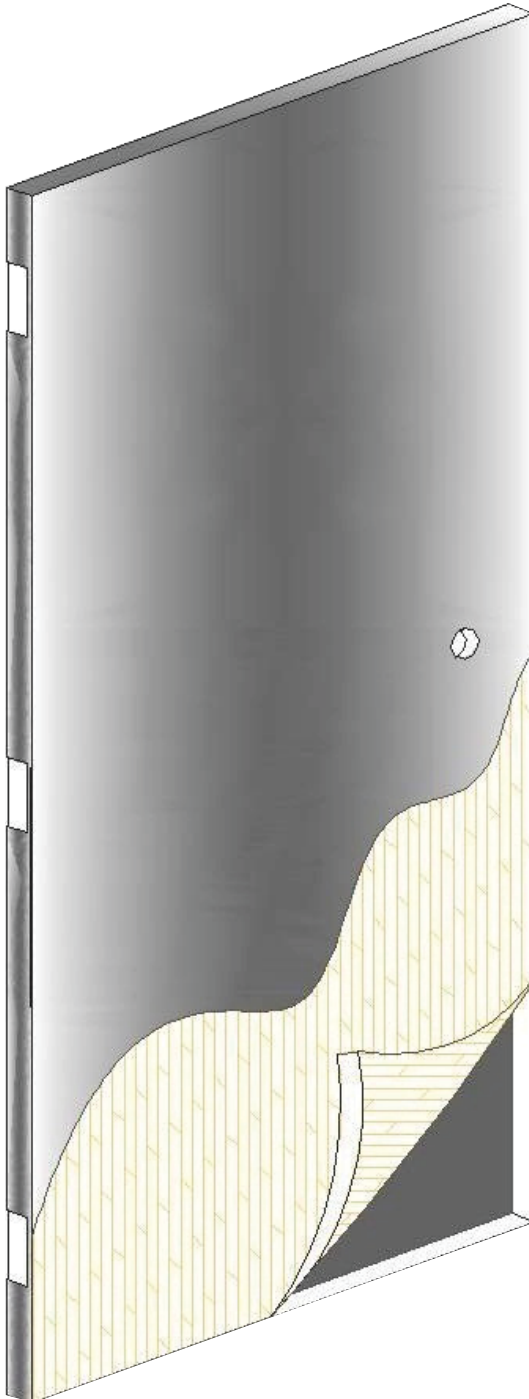

ADVANTAGE

1. High quality
2. effective radiation protection

STANDARD FEATURES

RADIATION SHIELDING CAPABILITIES

1. 44 mm standard door thickness
2. 2MM lead sheet located at door internal for radiation shielding.
3. Galvanized iron G40 - G60 - G90
4. Interlocking mechanical seam full height of door
5. 1.5mm G.I. hardware internal reinforcements
6. 6mm hinge reinforcements
7. heavy duty galvanized flush top cap
8. heavy duty galvanized inverted bottom cap

MATERIAL OPTIONS

1. 1.2mm or 1.5mm door skin
2. Rust inhibitive epoxy primer coat
ANSI SDI 250, 10 or powder coated as per required RAL color.
3. Insulation Options:
 - Rockwool
 - Honey Comb
 - Polyurethane Foam

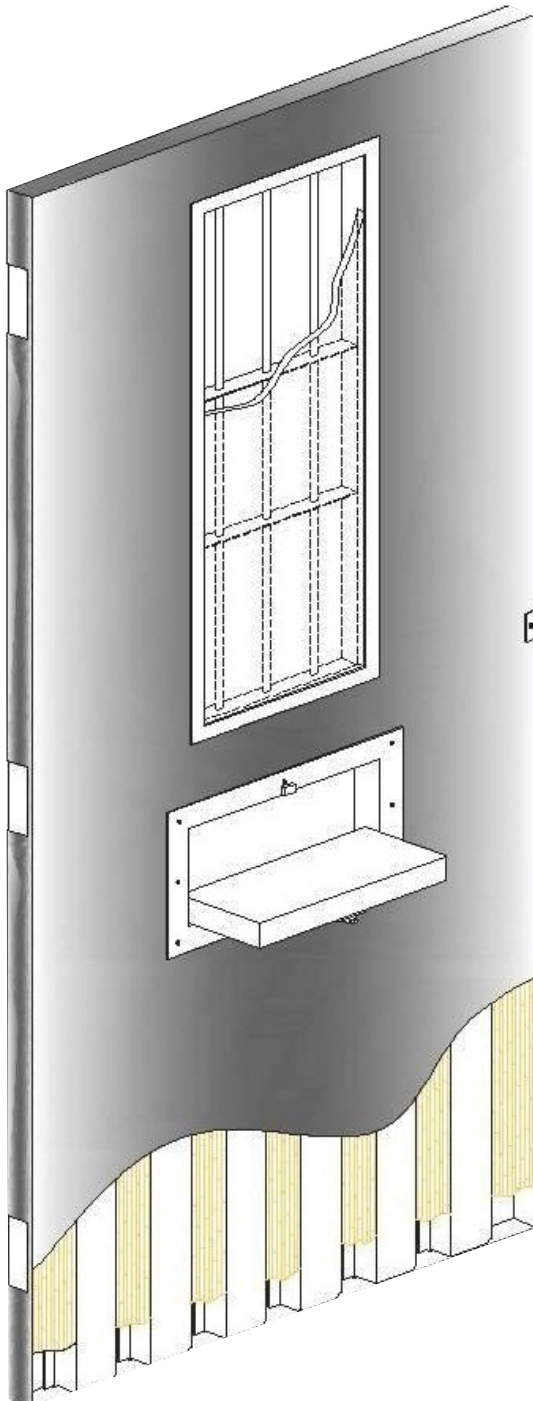
**STANDARD FEATURES**

1. 2mm door skin Galvanized Iron G40 , G60 & G90
2. Seamless panel
3. 1.5mm G.I. hardware internal reinforcements
4. 6mm hinge reinforcements
5. heavy duty galvanized flush top cap
6. heavy duty galvanized inverted bottom cap
7. Hat channel stiffener - 1.5mm G.I Sheet

MATERIAL OPTIONS

1. 44 mm standard door thickness
2. Core options - injected polyurethane
core-density 35-45 kg/m³ , mineral rockwool
core - density 100 kg/m³
3. Design options for food pass
4. Rust inhibitive epoxy primer coat
ANSI SDI 250, 10 or powder coated as per
required RAL color.

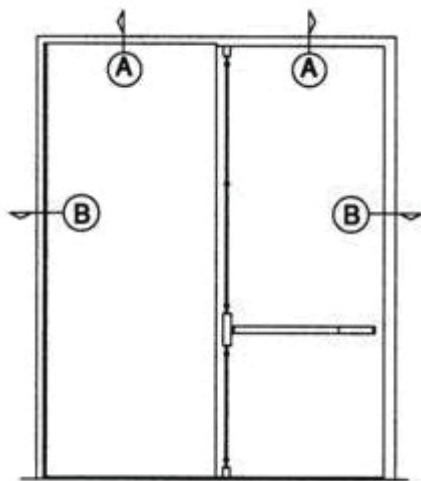

Typical Elevations

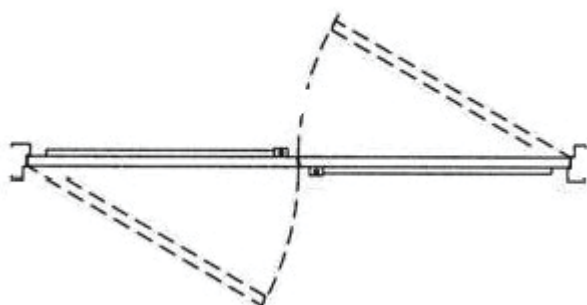
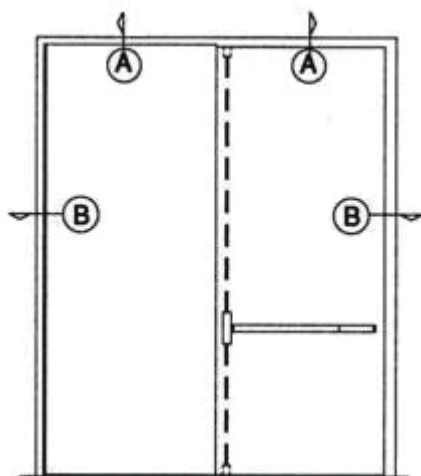

Typical Plan View

PRODUCT:

1 - 3 / 4" (44 mm) thick pairs of doors swinging in opposite directions.

Double egress assemblies permit traffic flow in both directions through the same opening.

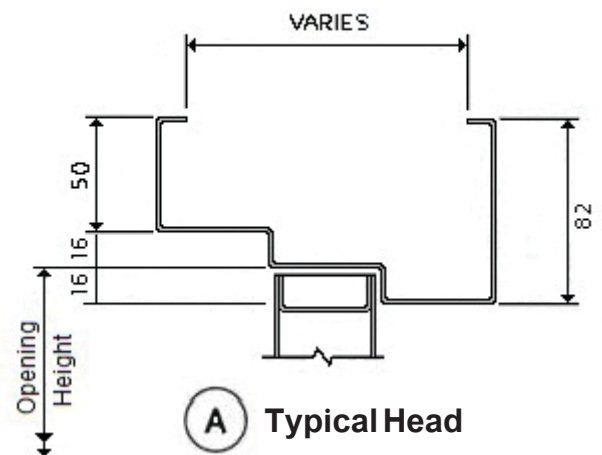

A Typical Head

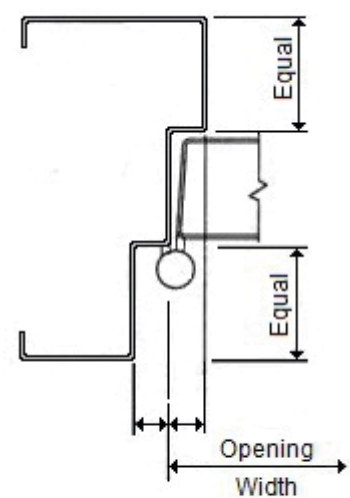

B Typical Jamb

NOMENCLATURE FOR STANDARD DOOR DESIGNS

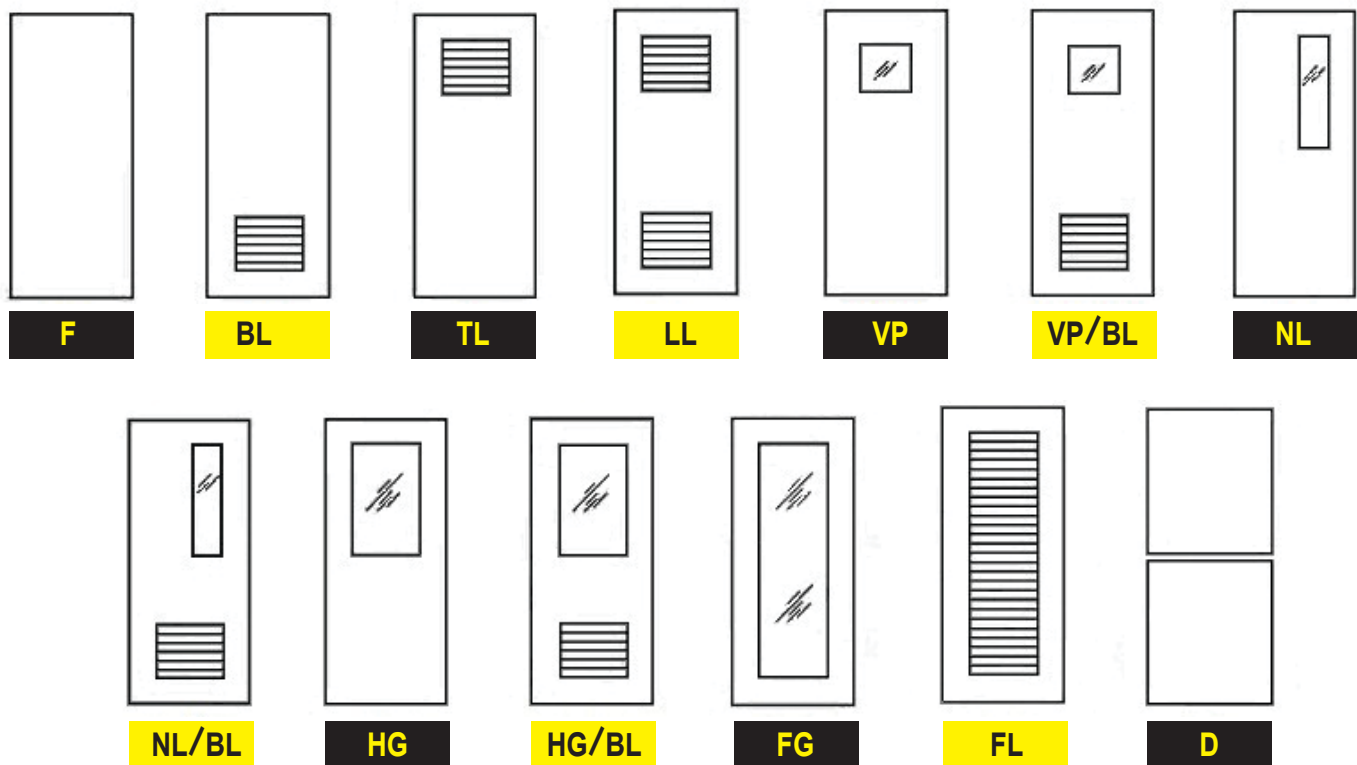

Nomenclature letter Symbols

F - Flush

BL - Louvered (bottom)

TL - Louvered (top)

LL - Louvered (top and bottom)

VP - Vision panel

VP/BL - Vision panel and bottom louvered

NL - Narrow Lite

NL/BL - Narrow lite and louvered (bottom)

HG - Half Glass

HG/BL - Halfglass and Louvered (bottom)

FG - Full Glass

FL - Full Louver

D - Dutch door

LOUVER OPTIONS

MENTION THE TYPES OF THE LOUVER

- 1 - standard pierced louver
- 2 - z blade louver
- 3 - fire rated louver

z blade louver

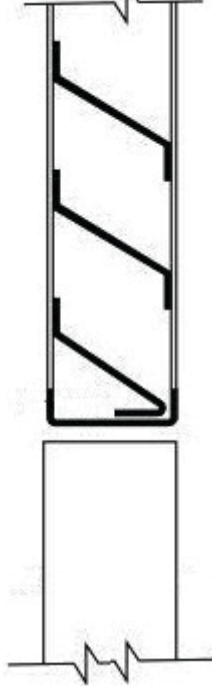

"Z" Blade

Operating lever

fire rated louver

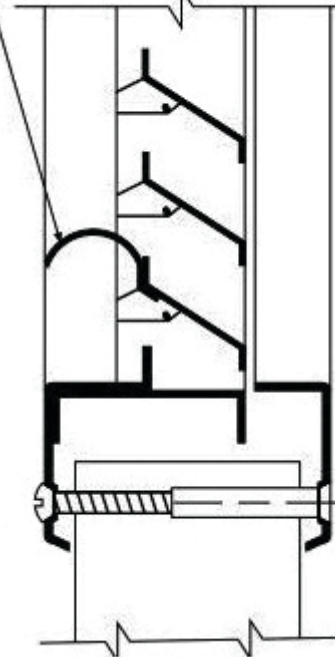

Fusible Link

standard pierced louver

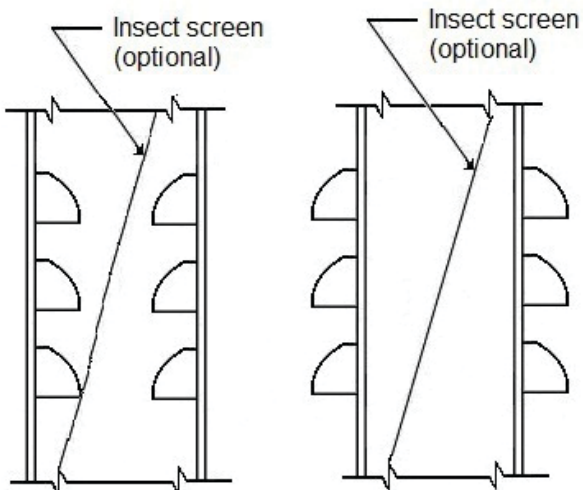

Pierced

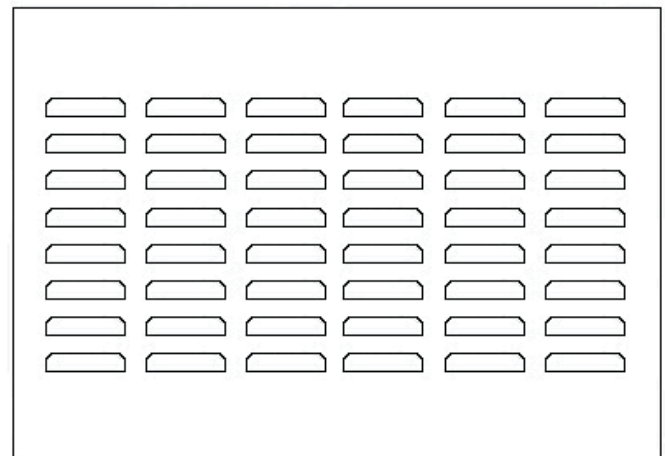

Louver Detail

LEAD LINED FRAME

STANDARD FEATURES

1. 2mm lead sheet on frame internals for radiation shielding
2. Galvanized Sheet G40 - G60 - G90
3. Mitered 45 degree frame connection.
4. 5mm hinge reinforcement 6 mm
5. CNC machined hardware cut out preparation.

MATERIAL OPTIONS

1. 1.5mm or 2.0mm door skin
2. Rust inhibitive epoxy primer coat ANSI SDI 250,10 or powder coated as per required RAL color.

DESIGN OPTIONS

1. Frame profile options, double rabbet, single rabbet
2. Wall anchoring options for masonry, wood stud and metal stud for dry wall.

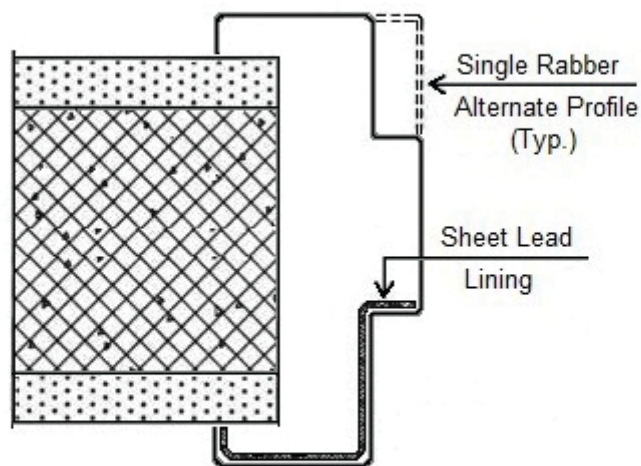

DOOR FRAMES

STANDARD FEATURES

1. Galvanized Sheet G40, G60 & G90
2. Mitered 45 degree frame connection.
3. 5 mm hinge reinforcement
4. CNC machined hardware cut out preparation.

MATERIAL OPTIONS

1. 1,2 mm or 1,5 mm door skin
2. Rust inhibitive epoxy primer coat ANSI SDI 250,10 or powder coated as per required RAL color.

DESIGN OPTIONS

1. Frame profile options, double rabbet, single rabbet, full weld slide in knockdown.
2. Wall anchoring options for masonry, wood stud and metal stud for dry wall.

FIRE PATING OPTIONS

1. ANSI/UL 10B, "fire test of door Assemblies," maximum 3 hours fire rated.
2. ANSI/UL 10C, "fire test of door Assemblies," maximum 1-1/2 hours fire rated.

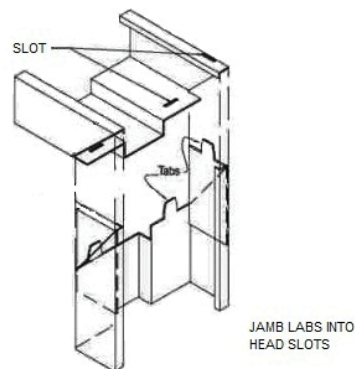
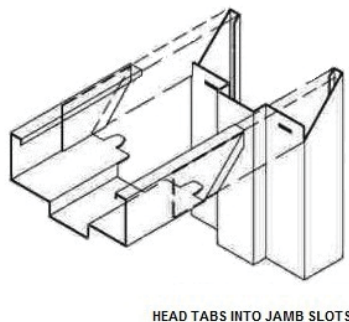
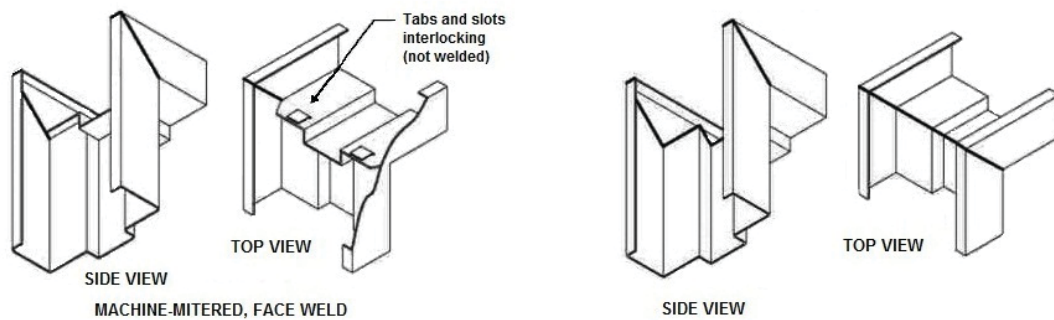

KNOCKDOWN FRAME CORNER DETAILS
WELDED FRAME CORNER DETAILS